

### 3-in-1 PROGRESS TRIKE MANUAL

Please read this Owner's Manual completely before assembling or operating this product.  
 Assembly of this product should be carried out by an adult.  
 Always wear an approved safety helmet when riding.  
 Never leave your child unattended on this product.  
 Not permitted for use on public roads or highways.  
 Please ensure you follow the assembly instructions, as some parts must be installed before others.  
 When adult is pushing the trike, please ensure child is wearing the seat belt and it is adjusted properly by adult first.  
 When letting the child ride trike by themselves, remove the push bar and remove the seat belt for your children's safety.



#### WARNING!

This product is not a stroller and does not meet the safety requirements for strollers.

Do not use as a means of transport.

Do not use on or near the road.

Toy should be used with caution since skill is required to avoid falls or collisions causing injury to the user or third parties.

#### PARTS LIST

	1		1		2
	1		2		1
	1		1		1
	1		1		1
	1		1		1
	1				

- A. Main Body
- B. Rear Axle + plastic spacer + plastic pin
- C. Parental push handle (bottom)
- D. Parental push handle (top)
- E. Front fork
- F. Handlebar
- G. Front wheel
- H. Rear wheel x 2
- I. Seat
- J. Seat Belt
- K. Wheel lock
- L. Pedal x 2
- M. Bucket
- N. Mud guard
- O. Protection ring
- P. 8x45mm Allen Bolt
- Q. 4.2x14mm Screw x 4
- T. 8x38mm Allen Bolt and Nut
- U. Allen key
- V. Spanner
- W. Head Rest

#### 1. ATTACH REAR AXLE TO MAIN FRAME ATTACH THE REAR WHEELS TO THE REAR AXLE

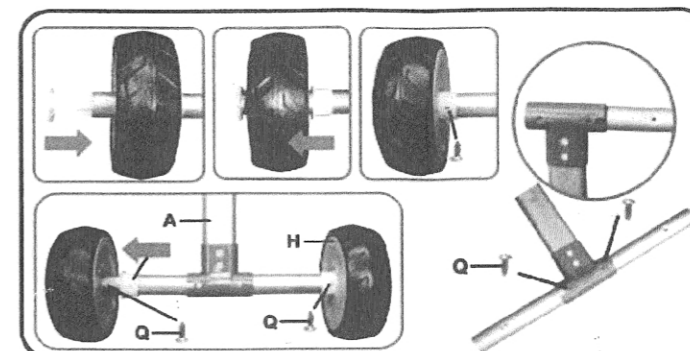

- A. Slide the rear axle (B) through the main body (A).
- B. Align the holes and secure with two 4.2x14mm Screw (Q).
- C. Slide one wheel plastic spacer onto each side of the rear axle (B).
- D. Slide one rear wheel (H) onto rear axle (B).
- E. Insert the plastic pin through the rear wheel and then into the rear axle.
- F. Ensure all holes in the plastic spacer, rear axle and plastic pin all align. Then secure with one 4.2x14mm Screw (Q).
- G. Repeat steps for other rear wheel.

#### 2. FRONT FORK ASSEMBLY:

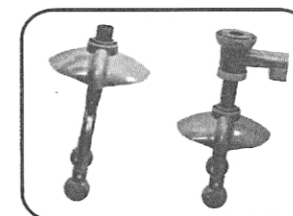

- A. Insert the mud guard (N) onto the front fork (E).
- B. Insert the front fork (E) into the head stem of the main body (A).

#### 3. HANDLE BAR ASSEMBLY:

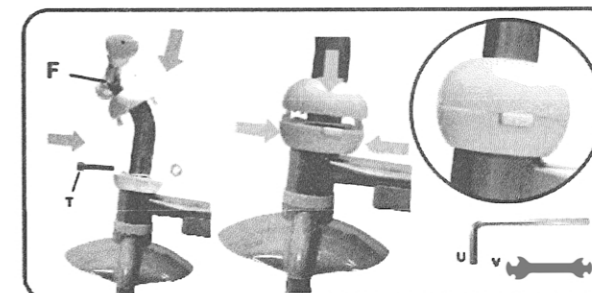

- A. Push the plastic cover up on the handle bars (F).
- B. Install the handle bar onto the front head stem. Secure with one 8x38mm Allen Bolt and nut (T).
- C. Push down plastic cover, ensuring that it locks into position correctly.

#### 4. FRONT WHEEL ATTACHMENT

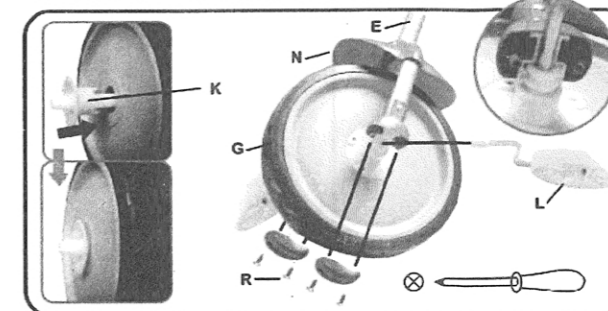

- A. Insert the wheel lock (K) into the front wheel (G).
- B. Turn the trike upside down and rest on the handlebars.
- C. Insert the pedals (L) into the front wheel (G). Ensure that the groove on the pedal line up with the slot in the wheel hub.
- D. Place the front wheel (G) onto the front fork (E). Ensure the wheel and pedals sit inside the white plastic washer, as pictured above.
- E. Place the front fork end caps over the pedals. Secure each with two 3.5x15mm screws.



## 5. SEAT AND REAR BUCKET ATTACHMENT

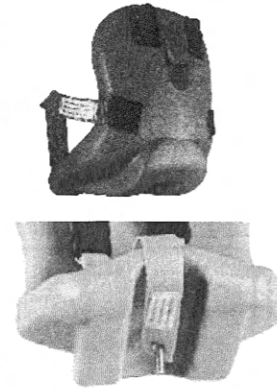
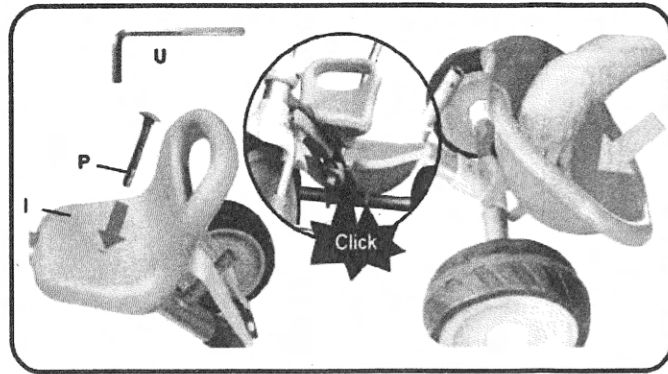

- Insert the 8x45mm Allen Bolt (P) through the seat (I).
- Place the bottom strap of the seat belt (J) over the bolt, so it looks like the above picture on right.
- Select the desired seat position on the main frame (A), then insert the bolt into the hole on the frame, tighten with Allen key.
- Attach the rear bucket to the rear axle, by pushing down on the bucket.
- Push the front of the bucket forward to attach it to the main frame.
- Ensure all 3 parts are locked correctly into position.

## 6. PUSH HANDLE ATTACHMENT

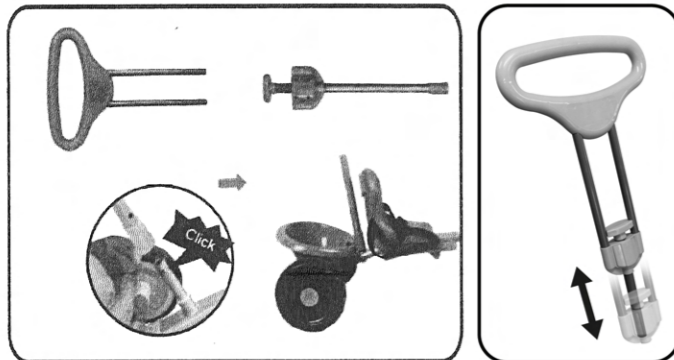

- Attach the top half of the parental push handle (D) to the bottom section (C), secure with the pre-installed screws in the lower section.
- Insert the lower half of the parental push handle (C) onto the back of the main frame. Ensure the spring loaded dimple on main frame comes through push handle arm and locks it into place.
- The push handle can be adjusted in different positions.

## 7. PROTECTION RING ATTACHMENT

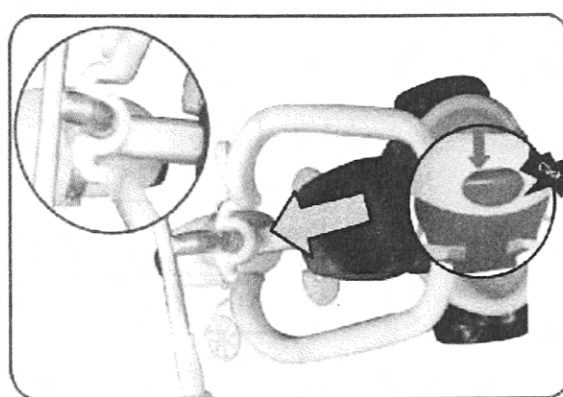

- Slide the protection ring (O) over the back of the seat and push the front of the protection ring around the handle bar stem. Ensure both the front and back have securely locked into position.

## 8. HEAD REST ATTACHMENT

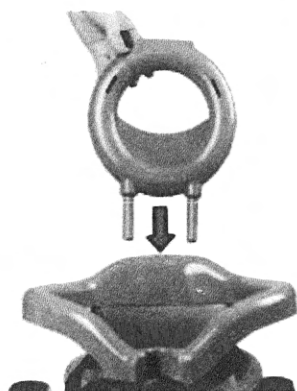

- Insert the head rest (W) into the back of the seat (I).

## 9. USING RETRACTABLE FOOT RESTS

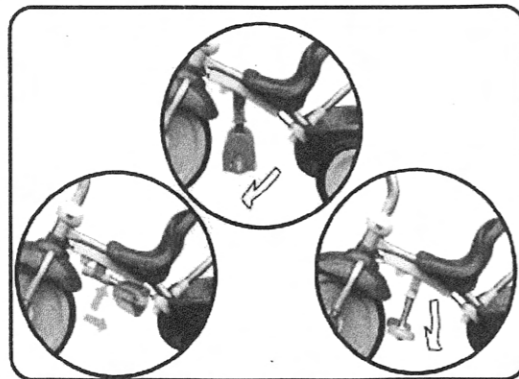

- Put down foot rest, by sliding the top plastic section to the right then pulling the tube down as shown above. Finally unfold the foot rest. To fold up please reverse the above.

## 10. USING FRONT WHEEL LOCK

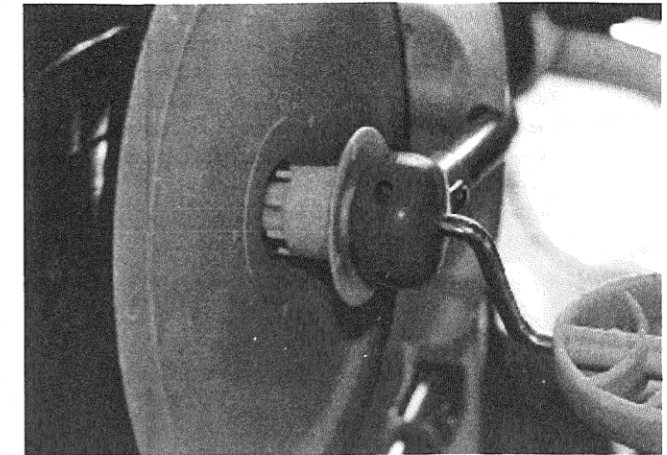
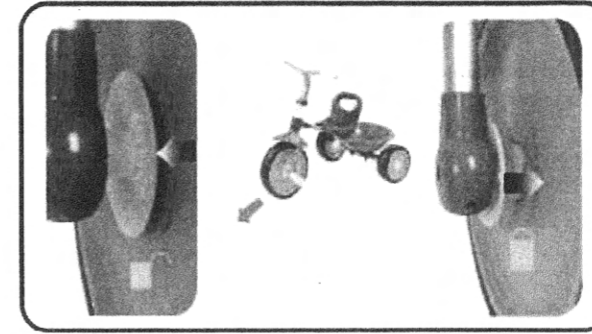

### Freewheel

- This function is to be used when parent is pushing a child, that can't or does not feel like pedaling the trike. It will allow the child to place their feet on the pedals or foot rest without the pedals turning.
  - To enable this function, pull out the wheel lock (K) towards the pedal, as shown above.

### Direct Drive

- This should be selected when child will be pedaling the trike by the pedals.
  - To enable this function press in the wheel lock (K) into the front wheel hub. Note: The triangles on the wheel lock and front wheel must be aligned to allow you to push in the wheel lock.

## USING STEERING LOCK

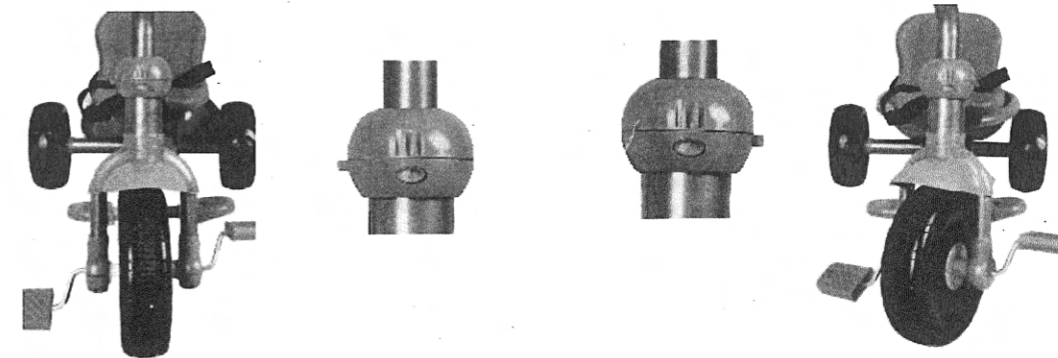

### Steering lock

- Push button shown above to the left to activate steering lock. Child will be unable to turn the handlebars.

### Steering

- Push button shown above to the right to activate steering. Child will be able to turn the handlebars.

Please note handlebar must be in straight position before you can push button.